

**Recommended Bass Reflex Type Enclosure for FW168N woofer**

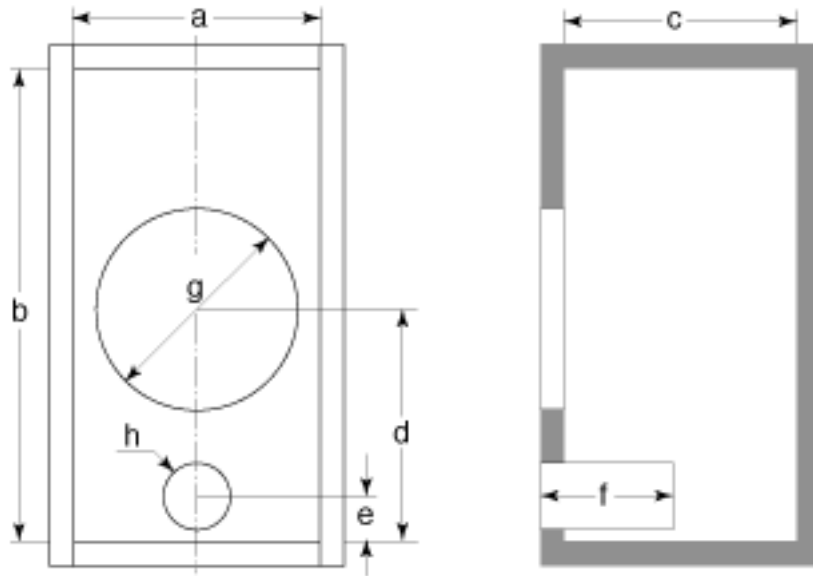

	<b>a</b>	<b>b</b>	<b>c</b>	<b>d</b>	<b>e</b>	<b>f</b>	<b>g</b>	<b>h</b>	Cubic Capacity	Board Thickness
<b>FW168 N</b>	184mm 7.24"	354mm 13.93"	174mm 6.85"	174mm 6.85"	34mm 1.33"	100mm 3.93"	Ø151mm Ø5.94"	Ø50mm Ø1.96"	11 litre	15mm 0.59"